

CASE STUDY

Horse Heaven Mine Site Jefferson County, Oregon

August 2010

**Prepared by
The Interstate Technology & Regulatory Council
Mining Waste Team**

Permission is granted to refer to or quote from this publication with the customary acknowledgment of the source. The suggested citation for this document is as follows:

ITRC (Interstate Technology & Regulatory Council). 2010. *Horse Heaven Mine Site, Jefferson County, Oregon*. Mining Waste Treatment Technology Selection Web. Washington, D.C.: Interstate Technology & Regulatory Council, Mining Waste Team. www.itrcweb.org.

Acknowledgements

The ITRC Mining Waste Team would like to acknowledge Oregon Department of Environmental Quality Project Manager Cliff Walkey, who completed the April 2008 Mine Waste Case Study Survey, from which the information in this case study is taken.

TABLE OF CONTENTS

1. SITE INFORMATION	1
1.1 Contacts.....	1
1.2 Name, Location, and Description.....	1
2. REMEDIAL ACTION AND TECHNOLOGIES.....	3
3. PERFORMANCE.....	4
4. COSTS	4
5. REGULATORY CHALLENGES	4
6. STAKEHOLDER CHALLENGES	5
7. OTHER CHALLENGES AND LESSONS LEARNED	5
8. REFERENCES	5

LIST OF FIGURES

Figure 1-1. Horse Heaven Mine site map	2
Figure 2-1. Unprotected mine portal.....	3
Figure 2-2. Dangerous open glory hole at head works	3
Figure 2-3. Storm-water retention basin	4
Figure 2-4. Installation of bat gate in mine portal	4

HORSE HEAVEN MINE SITE, JEFFERSON COUNTY, OREGON

1. SITE INFORMATION

1.1 Contacts

Cliff Walkey
Project Manager
Oregon Department of Environmental Quality
425 NE Bellevue Dr., Suite 110
Bend, OR 97701-7415
Telephone: 541-633-2003
E-mail: Walkey.cliff.@deq.state.or.us

1.2 Name, Location, and Description

The Horse Heaven Mine is an abandoned mercury mine located on approximately 40 acres approximately 17 miles due east from Ashwood, Oregon, Township 10 South, Range 18 East, Section 12, in Jefferson County (Figure 1-1). The latitude is 44° 30' 52.20" N; longitude is 120°, 30' 19.10" W. The site is extremely remote. The base zoning of the Horse Heaven Mine is exclusive farm use (rangeland). Although there are individual ranch homesteads within a few miles of the site, the nearest communities are Ashwood and Antelope. Geographically, the facility is located approximately 1,500 feet from Horse Heaven Creek, an ephemeral stream that discharges into Muddy Creek (Redband trout habitat).

The first deposit was discovered at Horse Heaven by Art Champion and Grover Keeton in 1933. In 1934, the prospect was sold to R. R. Whiting and C. C. Hayes, who developed the Number One level of the mine and produced 2,200 flasks of mercury over the next two years. In 1936, the Horse Heaven Mine was sold to the Sun Oil Company (Sunoco), and a subsidiary company (Horse Heaven Mines, Inc.) was formed to operate the mine. The mine was operated continuously until 1944, when a fire destroyed the furnace, power plant, and other structures. Total production at that time was 15,097 flasks of mercury. The mine closed in 1945 after cleanup operations produced another 74 flasks of mercury.

The mine was reopened in 1955 using a new 30-ton rotary furnace plant. During 1955–1958, the major pillars supporting the slopes and incline were removed, and the most productive part of the mine caved and was made inaccessible. Total production as of 1958 was 17,214 flasks of mercury. There does not appear to have been any production since that time. Ore rock consisted primarily of cinnabar that was processed through various furnaces located at the mine site. The current property owner of record is Ms. Susan Batterson of Everett, Washington. There is a seasonal residential cabin and outbuildings and historic structures related to the mining era.

The affected media at the site include soil, sediment and other process waste ore rock and calcine. Mercury and arsenic are the primary contaminants of concern.

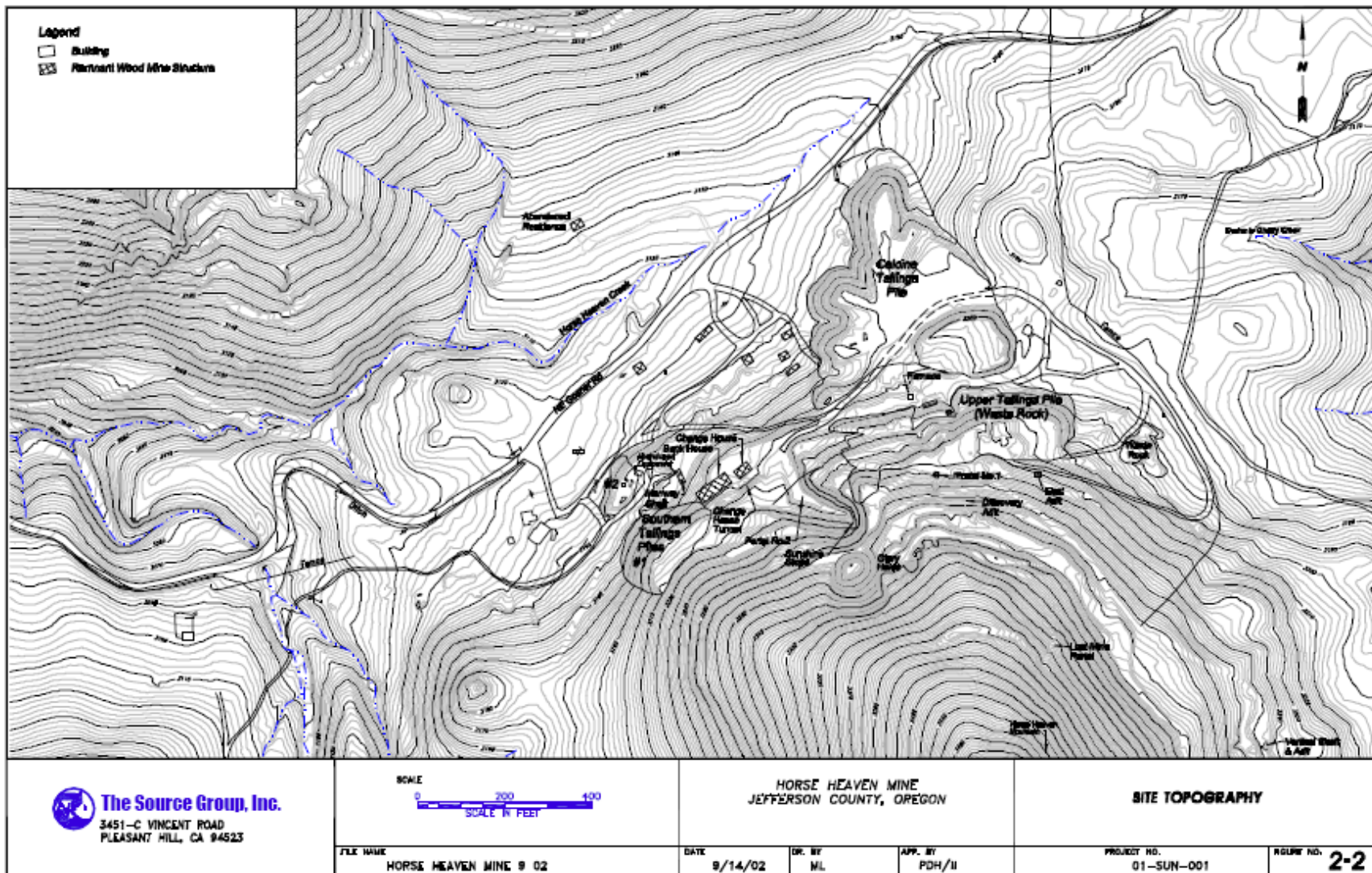

Figure 1-1. Horse Heaven Mine site map.

2. REMEDIAL ACTION AND TECHNOLOGIES

The Horse Heaven Site is in the Oregon Department of Environmental Quality's Voluntary Cleanup Program. The cleanup was conducted in compliance with the Comprehensive Environmental Compensation and Liability Act (CERCLA). A final record of decision (ROD) was posted in 2005, and remedial actions were completed in two phases during 2006 and 2007. The remedial action addressed the presence of mercury and arsenic in contaminated soils and groundwater as well as physical hazards represented by mine workings.

The objectives of the remedial action were as follows:

- Promote overall protection of human health and the environment.
- Prevent the tailings from being moved offsite by the public.
- Prevent the potential for off-site transport of the tailings via storm-water runoff.
- Remove mine dump refuse that was deposited off site.
- Protect the public from physical hazards associated with mine portals (Figures 2-1 and 2-2).
- Protect any suitable bat habitat associated with mine portals.



Figure 2-1. Unprotected mine portal.



Figure 2-2. Dangerous open glory hole at head works.

The remedial action consisted of the following elements:

- Excavation and on-site entombment and capping of D-furnace area soils
- Collection, entombment, and capping of solid waste mining debris on site
- Regrading of calcine tailings to mitigate mass wasting and off-site migration
- Abatement and mitigation of physical hazards represented by extant mine portals
- Construction of storm-water retention basins (Figure 2-3)
- Conservation of bat habitat (Figure 2-4)
- Institutional controls concerning use and access restrictions



Figure 2-3. Storm-water retention basin.



Figure 2-4. Installation of bat gate in mine portal.

Capping includes placement of alluvial sediments over a limited area associated with the D-tube furnace that had been documented to have elevated concentrations of mercury. Two settling ponds were also constructed for site storm-water retention. These retention basins were designed to eliminate any off-site migration of mine tailings.

3. PERFORMANCE

Effectiveness of the remedial actions is evaluated with required annual site inspections and reports that evaluate conformance with remedial goals and objectives. The first annual inspection report was performed and submitted in 2008 and documented that the remedy, as constructed, was protective as intended.

In addition, institutional controls were imposed through recordation with Jefferson County. Restrictive covenants govern future redevelopment capacity and requirements to maintain engineering control (fencing, signing). In addition, there are prohibitions on removal of calcine and/or other site material containing mercury.

4. COSTS

No information available.

5. REGULATORY CHALLENGES

Leaving large quantities of solid mine waste in place on site presents issues with long-term stewardship (LTS). LTS can include the use of restrictive and/or environmental covenants and implementation of a monitoring and maintenance plan. Restricting site access or allowing

continued use of the site for part time residency, recreational, or industrial purposes poses a unique set of challenges.

Due to the size of these mine waste sites, it is often not feasible to fence or otherwise block access to the site. Many members of the community do not recognize that the sites are private property and trespass frequently. This is especially true of historic mine site like Horse Heaven that become destinations for persons and groups interested in Oregon mining history. Monitoring and maintenance become the primary regulatory challenge in these instances, especially with respect to physical hazards associated with unstable ground and mine portals such as glory holes that are challenging with respect to limiting access to trespassers

6. STAKEHOLDER CHALLENGES

This site has litigation pending on mineral rights to calcine from former owner. The former owner (plaintiff) lost the first round but has appealed to 9th Circuit Court.

7. OTHER CHALLENGES AND LESSONS LEARNED

Engineering control has certain limitations at this specific site. Specifically, fencing was unfeasible at specific mine portals, and mass wasting compromises constructed fencing at specific locales. External bat surveys were feasible, but internal bat surveys were not.

Institutional controls were required to prevent uncontrolled off-site distribution of mercury-containing ore, country rock, and/or, calcine. Physical hazards needed to be addressed because Horse Heaven Mine is a destination for public, spelunkers, hobbyists, etc. The remedial action to address the physical hazards represented by mine portals while conserving bat habitat is unique, if not innovative. The seasonal resident required risk evaluation.

8. REFERENCES

Oregon Department of Environmental Quality, Eastern Region. 2005. “Record of Decision, Recommended Remedial Action for Horse Heaven Mine, Sunco.”